

位置 LOCATION

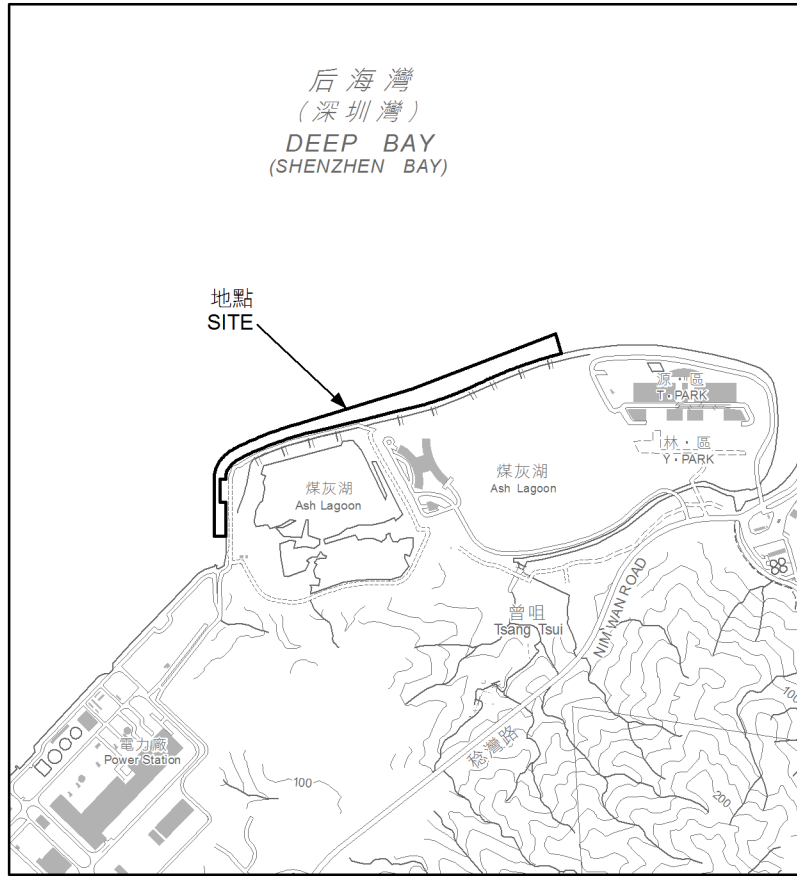

比例 SCALE 1:20 000

圖例 LEGEND

-  受影響的前濱及海床範圍
FORESHORE AND SEA-BED AFFECTED
-  擬建停泊設施
PROPOSED BERTHING FACILITIES
-  擬議海堤改動工程 / 停泊設施
PROPOSED MODIFICATION WORKS OF SEAWALL / BERTHING FACILITIES
-  擬建海水排水口
PROPOSED SEAWATER OUTFALL

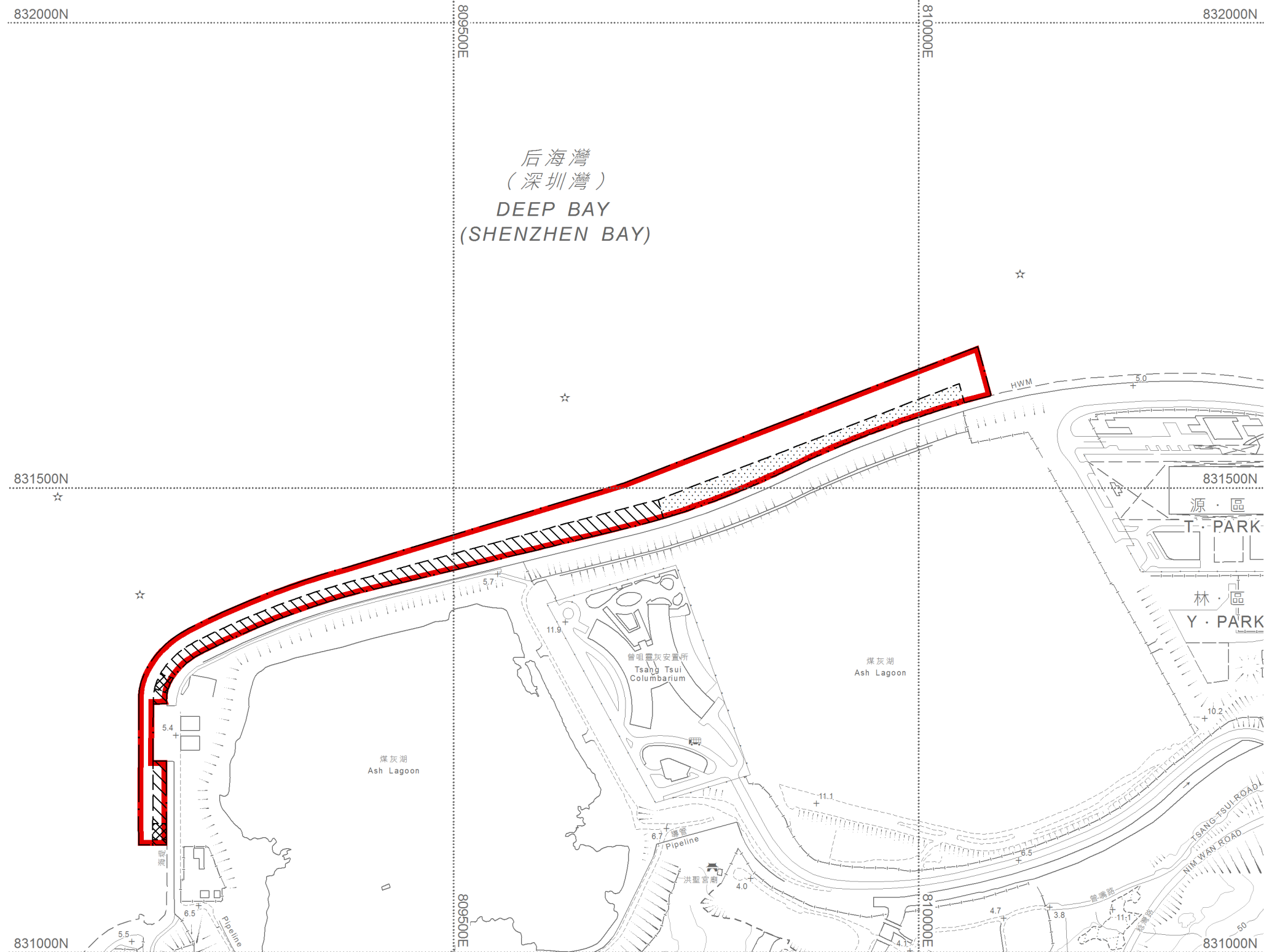

以紅色邊線標示的面積約為 4.41 公頃 EDGED RED AREA 4.41 HECTARES (ABOUT)

比例尺 SCALE 1:5 000

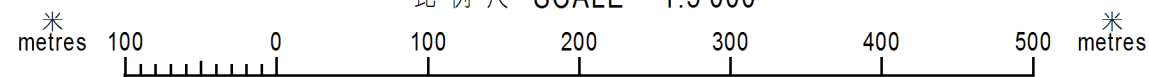

已簽署 SIGNED

(趙莉莉女士 Ms. CHIU Lee-lee, Lily)

副署長 (專業事務) Deputy Director / Specialist

地政總署 12 / 9 / 2024



Lands Department

圖則由屯門測量處繪製
Plan Prepared by District Survey Office, Tuen Mun

© 香港特別行政區政府 版權所有 Copyright reserved - Hong Kong SAR Government

前濱及海床(填海工程)條例(第127章)

屯門曾咀以北及以西的停泊設施及海水排水口建造工程

FORESHORE AND SEA-BED (RECLAMATIONS) ORDINANCE (CHAPTER 127)

CONSTRUCTION OF BERTHING FACILITIES AND SEAWATER OUTFALLS

AT THE NORTH AND WEST OF TSANG TSUI, TUEN MUN

檔案編號 File Nos. DLOTM 230/4/405A & LD DSO/TM/13/11

底圖編號 Base Map No. 5-NE-C (HP5C)

發展藍圖編號 Layout Plan No. -----

參考圖編號 Reference Plan No. 4110377/BIN/GN/013-1 (EPD)

圖則編號 PLAN No. TMM4573

日期 Date: 14/08/2024